

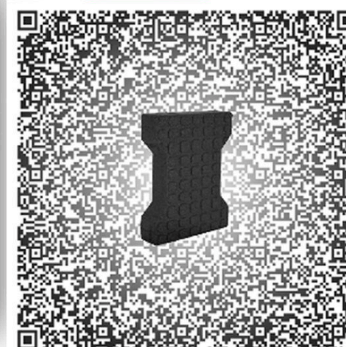

# I-Tile

Roll-Tech Molding  
Products, LLC



Scan With Smart Device

## RMP

Over the years Roll-Tech has developed and improved the technology in the making of rubber tires and other rubber products. Now, Roll-Tech is diversifying and offers pavers that can be used practically anywhere.



[www.roll-tech.net](http://www.roll-tech.net)

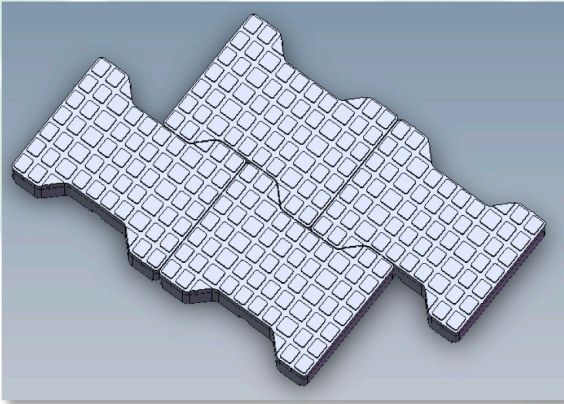

## Functionality

I-Tiles are rubber pavers which offer a tough interlocking surface for various treads and pressures. Easy to install, I-Tiles can be assembled to cover large or small spaces in a time-effective manner.

### Applications:

- ◆ Covers small or large surfaces
- ◆ Offers diversity whether to be used for décor or heavy-duty industrial purpose:
  - ◆ Patios/Terraces
  - ◆ Parks/Playgrounds
  - ◆ Swimming pool walkways
  - ◆ Entranceways/Driveways
  - ◆ Recreational, Residential, Commercial
  - ◆ Machine Shop Flooring
  - ◆ And any other practical applications

## Benefits



- ◆ Easy installation
- ◆ Eco-Friendly
- ◆ Lightweight
- ◆ Durable
- ◆ Better Traction
- ◆ Cushions Weight
- ◆ Soundproof
- ◆ Shock Absorbent
- ◆ High Traffic Resistance

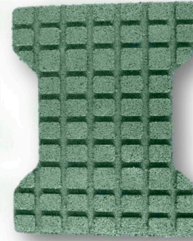

Black I-Tile  
 Material: Rubber  
 Dimensions: 6 3/8" x 7 7/8" x 1 5/8"  
 Weight: 2.65 lbs  
 Per Sq.Ft. 3.45



Green I-Tile  
 Material: Rubber  
 Dimensions: 6 3/8" x 7 7/8" x 1 5/8"  
 Weight: 2.65 lbs  
 Per Sq.Ft. 3.45



ASK US ABOUT OUR  
NEW COLORS

## Eco-Friendly



I-Tiles are made of 100% recycled rubber following Roll -Tech's all-green Quality Management System. This makes them perfect for landscaping, play areas, athletic fields, and other high-traffic areas.

**New Dealer Opportunities Now Available!**

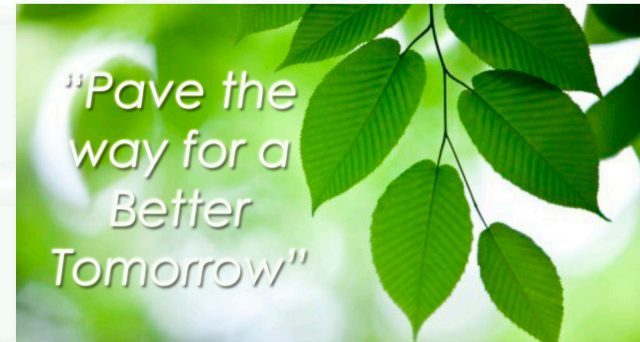

## Contact Us

Toll Free: 866-431-4515

Email: [sales@rolltech.net](mailto:sales@rolltech.net)

Shop Online: [www.roll-tech.net](http://www.roll-tech.net)



Roll-Tech Molding Products, LLC  
 243 Performance Drive SE  
 Hickory, NC 28602