



I-Tile

RMP

Over the years Roll-Tech has developed and improved the technology in the making of rubber tires and other rubber products. Now, Roll-Tech is diversifying and offers pavers that can be used practically anywhere.



Roll-Tech Molding
 Products, LLC

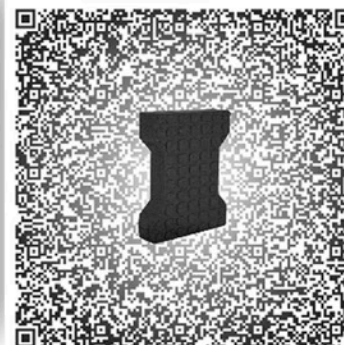

Scan With Smart Device

www.roll-tech.net

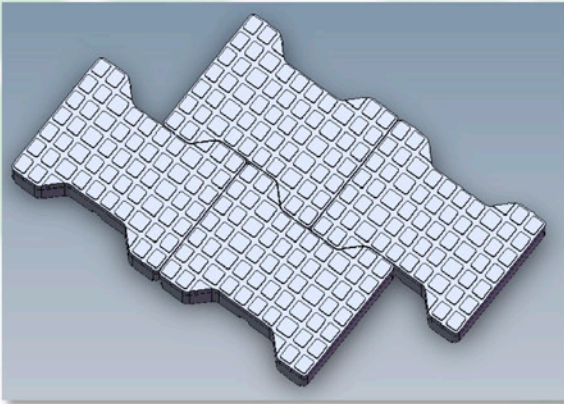

Functionality

I-Tiles are rubber pavers which offer a tough interlocking surface for various treads and pressures. Easy to install, I-Tiles can be assembled to cover large or small spaces in a time-effective manner.

Applications:

- ◆ Covers small or large surfaces
- ◆ Offers diversity whether to be used for décor or heavy-duty industrial purpose:
 - ◆ Patios/Terraces
 - ◆ Parks/Playgrounds
 - ◆ Swimming pool walkways
 - ◆ Entranceways/Driveways
 - ◆ Recreational, Residential, Commercial
 - ◆ Machine Shop Flooring
 - ◆ And any other practical applications

Benefits



- ◆ Easy installation
- ◆ Eco-Friendly
- ◆ Lightweight
- ◆ Durable
- ◆ Better Traction
- ◆ Cushions Weight
- ◆ Soundproof
- ◆ Shock Absorbent
- ◆ High Traffic Resistance



Black I-Tile
 Material: Rubber
 Dimensions: 6 3/8" x 7 7/8" x 1 5/8"
 Weight: 2.65 lbs
 Per Sq.Ft. 3.45



Green I-Tile
 Material: Rubber
 Dimensions: 6 3/8" x 7 7/8" x 1 5/8"
 Weight: 2.65 lbs
 Per Sq.Ft. 3.45



ASK US ABOUT OUR
NEW COLORS

Eco-Friendly



I-Tiles are made of 100% recycled rubber following Roll -Tech's all-green Quality Management System. This makes them perfect for landscaping, play areas, athletic fields, and other high-traffic areas.

New Dealer Opportunities Now Available!



Contact Us

Toll Free: 866-431-4515

Email: sales@rolltech.net

Shop Online: www.roll-tech.net



Roll-Tech Molding Products, LLC
 243 Performance Drive SE
 Hickory, NC 28602